



SUNNICA ENERGY FARM

EN010106

Volume 2

2.4 Traffic Regulation Measures Plans – Temporary Measures

APFP Regulation 5(2)(o)

Planning Act 2008

Infrastructure Planning (Applications: Prescribed Forms and
Procedure) Regulations 2009



Planning Act 2008

**The Infrastructure Planning
(Applications: Prescribed Forms and
Procedure) Regulations 2009**

Sunnica Energy Farm

2.4 Traffic Regulation Measures Plans – Temporary Measures

Regulation Reference:	Regulation 5(2)(o)
Planning Inspectorate Scheme Reference	EN010106
Application Document Reference	EN010106/APP/2.4
Author	Sunnica Energy Farm Project Team

Version	Date	Status of Version
Rev 00	18 November 2021	Application Version
Rev 01	30 August 2022	Change Application

Project Management Initials: Designer: DC
 Latest Revision Initials: Checked: DC
 Project Reference Number: 60589004

Checked: CEC
 Approved: CC

ISO A3 420mm x 297mm

Last saved by: HATTONCM (2022-08-23) Last Printed: 2022-08-25
 Filename: I:\A\AECOM\NET\COM\FS\ENEA\ST\ALBANS\UNST\1\LEGAC\Y\PROJECTS\SUNNICA ENERGY FARMES APPLICATION\CAD\TDRS\WIP\TRAFFIC REGULATION MEASURES_S\HETS_TM.DWG

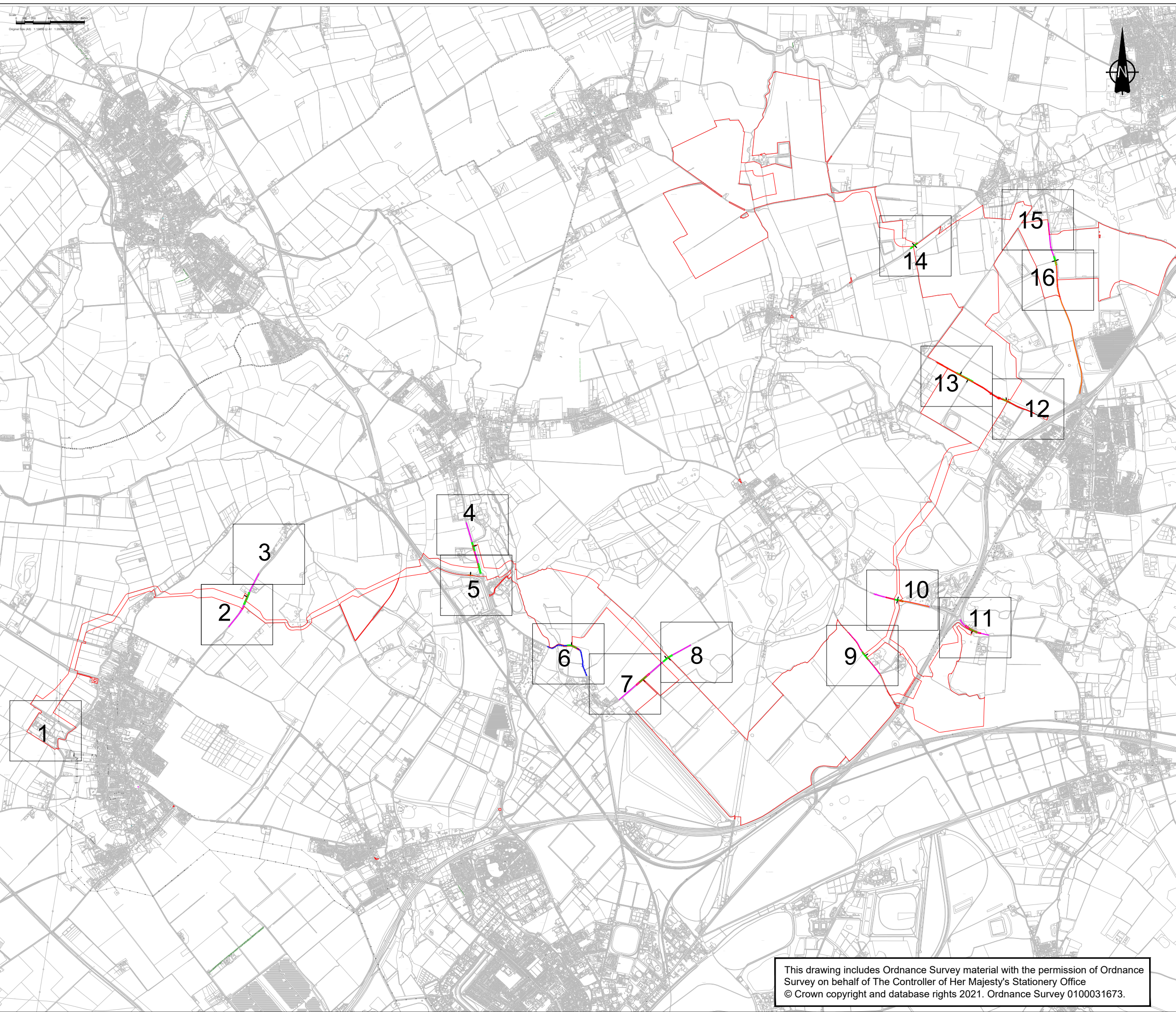

CONSULTANT

AECOM House, 63-77 Victoria Street,
 St. Albans, Hertfordshire, AL1 3ER
 +44(0)1727 535000 tel
 +44(0)1727 535099 fax
 www.aecom.com

PROJECT

Sunnica Energy Farm

CLIENT



NOTE

1. THE TRAFFIC REGULATION MEASURES PLANS SHOULD BE READ IN CONJUNCTION WITH THE DEVELOPMENT CONSENT ORDER AND THE OTHER PLANS AND DOCUMENTS TO BE CERTIFIED BY IT, IN PARTICULAR ARTICLES 11 AND 44 OF, AND SCHEDULES 6 AND 14 TO, THE DEVELOPMENT CONSENT ORDER.
2. THE INDICATIVE ACCESS LOCATIONS SHOWN ON THESE PLANS INDICATE THE GENERAL LOCATION OF THE ACCESSES TO WHICH THE TEMPORARY TRAFFIC SIGNAL MEASURES AND TEMPORARY PROHIBITION MEASURE DESCRIBED IN PARTS 2 AND 4 OF SCHEDULE 14 TO THE DEVELOPMENT CONSENT ORDER, RELATE. THESE PLANS DO NOT SHOW ALL PROPOSED ACCESSES TO THE AUTHORISED DEVELOPMENT. FURTHER INFORMATION ON THE PROPOSED ACCESSES TO THE AUTHORISED DEVELOPMENT CAN BE FOUND IN THE ACCESS AND RIGHTS OF WAY PLANS AND SCHEDULE 7 TO THE DRAFT DCO.
3. THE REQUIREMENT FOR TS1 HAS BEEN REMOVED AND TRAFFIC SIGNALS START AT TS2.

KEY

- ORDER LIMITS
- PROPOSED TEMPORARY SPEED LIMIT (30MPH SPEED LIMIT)
- PROPOSED TEMPORARY SPEED LIMIT (40MPH SPEED LIMIT)
- - - PROPOSED TEMPORARY TRAFFIC SIGNAL CONTROL AREA
- - - PROPOSED TEMPORARY PROHIBITION ORDER
- INDICATIVE SITE ACCESS LOCATION

Document Reference: EN010106/APP/2.4

ISSUE/REVISION

I/R	DATE	DESCRIPTION
1	30/08/2022	CHANGE APPLICATION JULY 2022
0	18/11/2021	FOR DCO SUBMISSION

SHEET TITLE

TRAFFIC REGULATION MEASURES PLANS -
 TEMPORARY MEASURES
 INFRASTRUCTURE PLANNING
 (APPLICATIONS: PRESCRIBED FORMS AND
 PROCEDURE) REGULATIONS 2009 5(2)(O)
 SHEET PLAN

SHEET NUMBER

60589004-TRM-TM-000

SCALE

On drawing

This drawing includes Ordnance Survey material with the permission of Ordnance Survey on behalf of The Controller of Her Majesty's Stationery Office © Crown copyright and database rights 2021. Ordnance Survey 0100031673.

This drawing has been prepared for the use of AECOM's client. It may not be used, modified, reproduced or relied upon by third parties, except as agreed by AECOM or as required by law. AECOM accepts no responsibility, and denies any liability whatsoever, to any party that uses or relies on this drawing without AECOM's express written consent. Do not scale this document.

Project Management Initials: Designer: DC
 Latest Revision Initials: Checked: DC
 Project Reference Number: 60589004

Checked: CEC Approved: CC

ISO A3 420mm x 297mm

Last saved by: HATTONCM(2022-08-23) Last Printed: 2022-08-25
 Filename: \\NA.AECOM\NET\COM\FSE\ENEA\STALBANS\UNSTAT\LEGACY\PROJECTS\UNNICA ENERGY FARMES APPLICATION\CA\T\TROSS\WP\TRAFFIC REGULATION MEASURES_S\HETS_TM.DWG

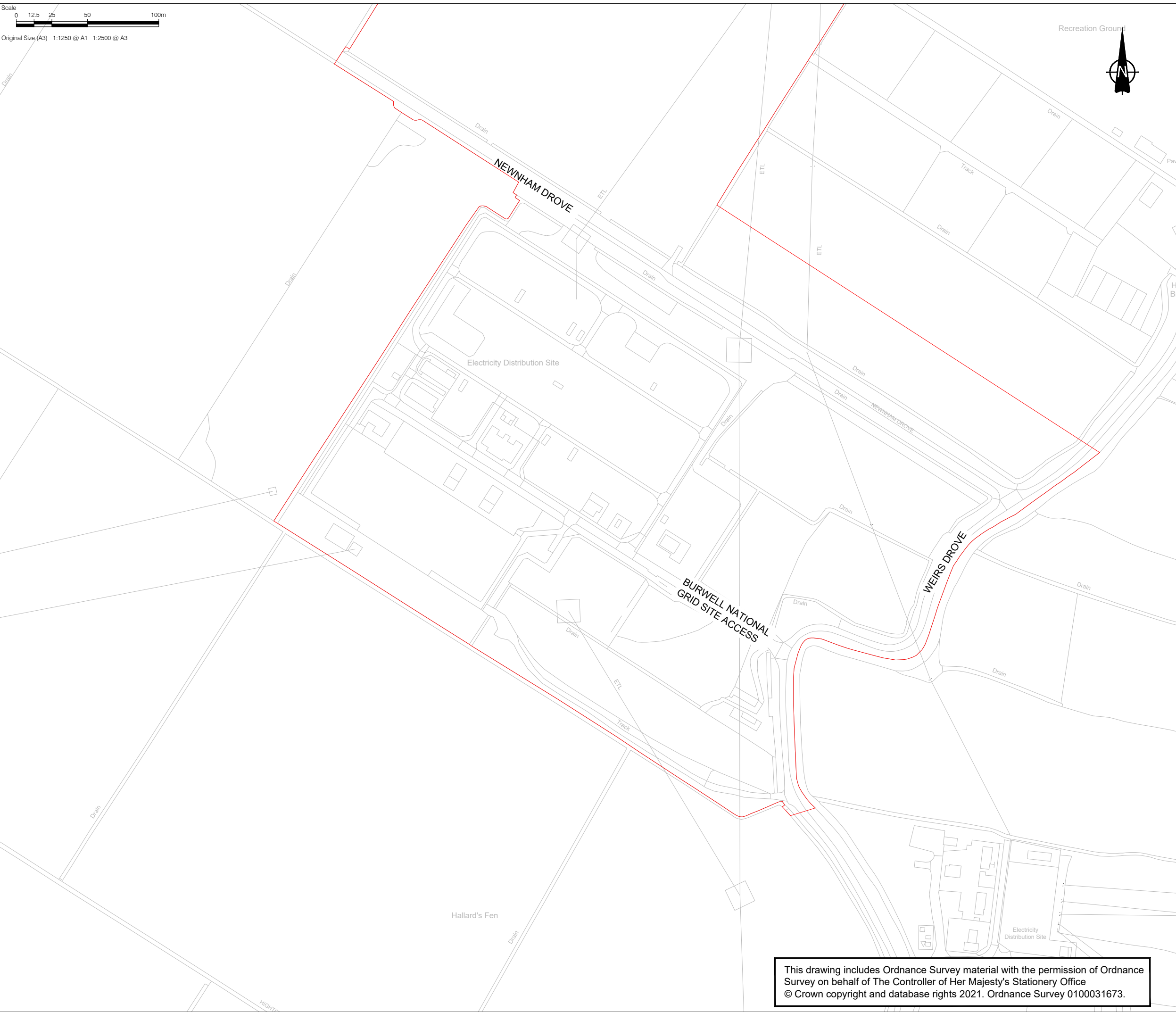

CONSULTANT

AECOM House, 63-77 Victoria Street,
 St. Albans, Hertfordshire, AL1 3ER
 +44(0)1727 535000 tel
 +44(0)1727 535099 fax
 www.aecom.com

PROJECT

Sunnica Energy Farm

CLIENT



NOTE

1. THE TRAFFIC REGULATION MEASURES PLANS SHOULD BE READ IN CONJUNCTION WITH THE DEVELOPMENT CONSENT ORDER AND THE OTHER PLANS AND DOCUMENTS TO BE CERTIFIED BY IT, IN PARTICULAR ARTICLES 11 AND 44 OF, AND SCHEDULES 6 AND 14 TO, THE DEVELOPMENT CONSENT ORDER.
2. THE INDICATIVE ACCESS LOCATIONS SHOWN ON THESE PLANS INDICATE THE GENERAL LOCATION OF THE ACCESSES TO WHICH THE TEMPORARY TRAFFIC SIGNAL MEASURES AND TEMPORARY PROHIBITION MEASURE DESCRIBED IN PARTS 2 AND 4 OF SCHEDULE 14 TO THE DEVELOPMENT CONSENT ORDER, RELATE. THESE PLANS DO NOT SHOW ALL PROPOSED ACCESSES TO THE AUTHORISED DEVELOPMENT. FURTHER INFORMATION ON THE PROPOSED ACCESSES TO THE AUTHORISED DEVELOPMENT CAN BE FOUND IN THE ACCESS AND RIGHTS OF WAY PLANS AND SCHEDULE 7 TO THE DRAFT DCO.
3. THE REQUIREMENT FOR TS1 HAS BEEN REMOVED AND TRAFFIC SIGNALS START AT TS2.

KEY

- ORDER LIMITS
- PROPOSED TEMPORARY SPEED LIMIT (30MPH SPEED LIMIT)
- PROPOSED TEMPORARY SPEED LIMIT (40MPH SPEED LIMIT)
- PROPOSED TEMPORARY TRAFFIC SIGNAL CONTROL AREA
- PROPOSED TEMPORARY PROHIBITION ORDER
- ➔ INDICATIVE SITE ACCESS LOCATION

SHEET PLAN

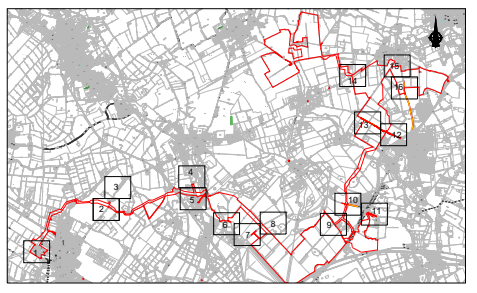

Document Reference: EN010106/APP/2.4

ISSUE/REVISION

I/R	DATE	DESCRIPTION
1	30/08/2022	CHANGE APPLICATION JULY 2022
0	18/11/2021	FOR DCO SUBMISSION

SHEET TITLE

TRAFFIC REGULATION MEASURES PLANS -
 TEMPORARY MEASURES
 INFRASTRUCTURE PLANNING
 (APPLICATIONS: PRESCRIBED FORMS AND
 PROCEDURE) REGULATIONS 2009 5(2)(O)
 SHEET 1 OF 16

SHEET NUMBER

60589004-TRM-TM-001

SCALE

1:2500 @ A3

This drawing includes Ordnance Survey material with the permission of Ordnance Survey on behalf of The Controller of Her Majesty's Stationery Office © Crown copyright and database rights 2021. Ordnance Survey 0100031673.

This drawing has been prepared for the use of AECOM's client. It may not be used, modified, reproduced or relied upon by third parties, except as agreed by AECOM or as required by law. AECOM accepts no responsibility, and denies any liability whatsoever, to any party that uses or relies on this drawing without AECOM's express written consent. Do not scale this document.

Project Management Initials: Designer: DC
 Latest Revision Initials: Checked: DC
 Project Reference Number: 60589004

Last saved by: HATTONCM(2022-08-23) Last Printed: 2022-08-25
 Filename: \\NA.AECOM\NET\COM\FSE\ENEA\STALBANS\UNST\1\LEGACY\PROJECTS\SUNNICA ENERGY FARMES APPLICATION\CAD\TROSS\WP\TRAFFIC REGULATION MEASURES_S\HETS_1M.DWG

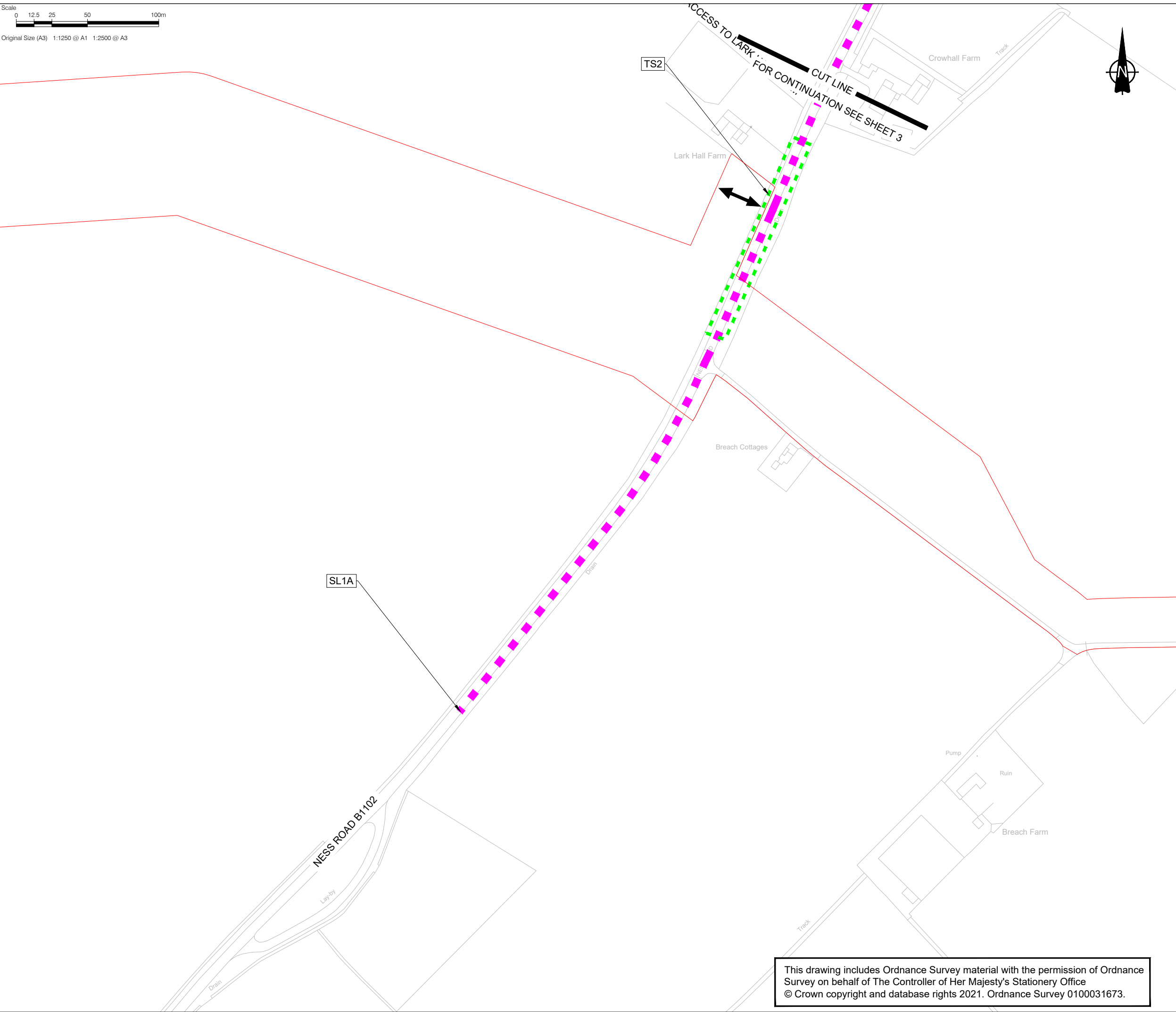

CONSULTANT

AECOM House, 63-77 Victoria Street,
 St. Albans, Hertfordshire, AL1 3ER
 +44(0)1727 535000 tel
 +44(0)1727 535099 fax
 www.aecom.com

PROJECT

Sunnica Energy Farm

CLIENT



NOTE

1. THE TRAFFIC REGULATION MEASURES PLANS SHOULD BE READ IN CONJUNCTION WITH THE DEVELOPMENT CONSENT ORDER AND THE OTHER PLANS AND DOCUMENTS TO BE CERTIFIED BY IT, IN PARTICULAR ARTICLES 11 AND 44 OF, AND SCHEDULES 6 AND 14 TO, THE DEVELOPMENT CONSENT ORDER.
2. THE INDICATIVE ACCESS LOCATIONS SHOWN ON THESE PLANS INDICATE THE GENERAL LOCATION OF THE ACCESSES TO WHICH THE TEMPORARY TRAFFIC SIGNAL MEASURES AND TEMPORARY PROHIBITION MEASURE DESCRIBED IN PARTS 2 AND 4 OF SCHEDULE 14 TO THE DEVELOPMENT CONSENT ORDER, RELATE. THESE PLANS DO NOT SHOW ALL PROPOSED ACCESSES TO THE AUTHORISED DEVELOPMENT. FURTHER INFORMATION ON THE PROPOSED ACCESSES TO THE AUTHORISED DEVELOPMENT CAN BE FOUND IN THE ACCESS AND RIGHTS OF WAY PLANS AND SCHEDULE 7 TO THE DRAFT DCO.
3. THE REQUIREMENT FOR TS1 HAS BEEN REMOVED AND TRAFFIC SIGNALS START AT TS2.

KEY

- ORDER LIMITS
- PROPOSED TEMPORARY SPEED LIMIT (30MPH SPEED LIMIT)
- PROPOSED TEMPORARY SPEED LIMIT (40MPH SPEED LIMIT)
- PROPOSED TEMPORARY TRAFFIC SIGNAL CONTROL AREA
- PROPOSED TEMPORARY PROHIBITION ORDER
- ↔ INDICATIVE SITE ACCESS LOCATION

SHEET PLAN

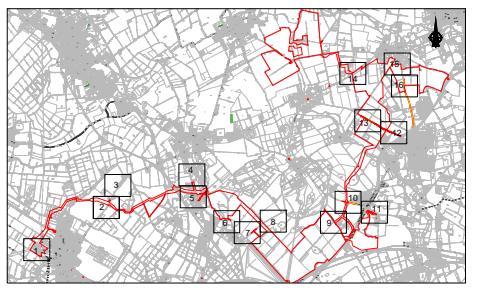

Document Reference: EN010106/APP/2.4

ISSUE/REVISION

I/R	DATE	DESCRIPTION
1	30/08/2022	CHANGE APPLICATION JULY 2022
0	18/11/2021	FOR DCO SUBMISSION

SHEET TITLE

TRAFFIC REGULATION MEASURES PLANS -
 TEMPORARY MEASURES
 INFRASTRUCTURE PLANNING
 (APPLICATIONS: PRESCRIBED FORMS AND
 PROCEDURE) REGULATIONS 2009 5(2)(O)
 SHEET 2 OF 16

SHEET NUMBER

60589004-TRM-TM-002

SCALE

1:2500 @ A3

This drawing includes Ordnance Survey material with the permission of Ordnance Survey on behalf of The Controller of Her Majesty's Stationery Office © Crown copyright and database rights 2021. Ordnance Survey 0100031673.

This drawing has been prepared for the use of AECOM's client. It may not be used, modified, reproduced or relied upon by third parties, except as agreed by AECOM or as required by law. AECOM accepts no responsibility, and denies any liability whatsoever, to any party that uses or relies on this drawing without AECOM's express written consent. Do not scale this document.

Project Management Initials: Designer: DC
 Latest Revision Initials: Checked: DC
 Project Reference Number: 60589004

Last saved by: HATTONCM(2022-08-23) Last Printed: 2022-08-25
 Filename: \\NA.AECOM\NET\COM\FS\EN\EA\ST\ALBANS\UNSTAT\LEGACY\PROJECTS\UNNICA ENERGY FARMES APPLICATION\CAD\TROSS\WP\TRAFFIC REGULATION MEASURES_S\HEETS_TM.DWG

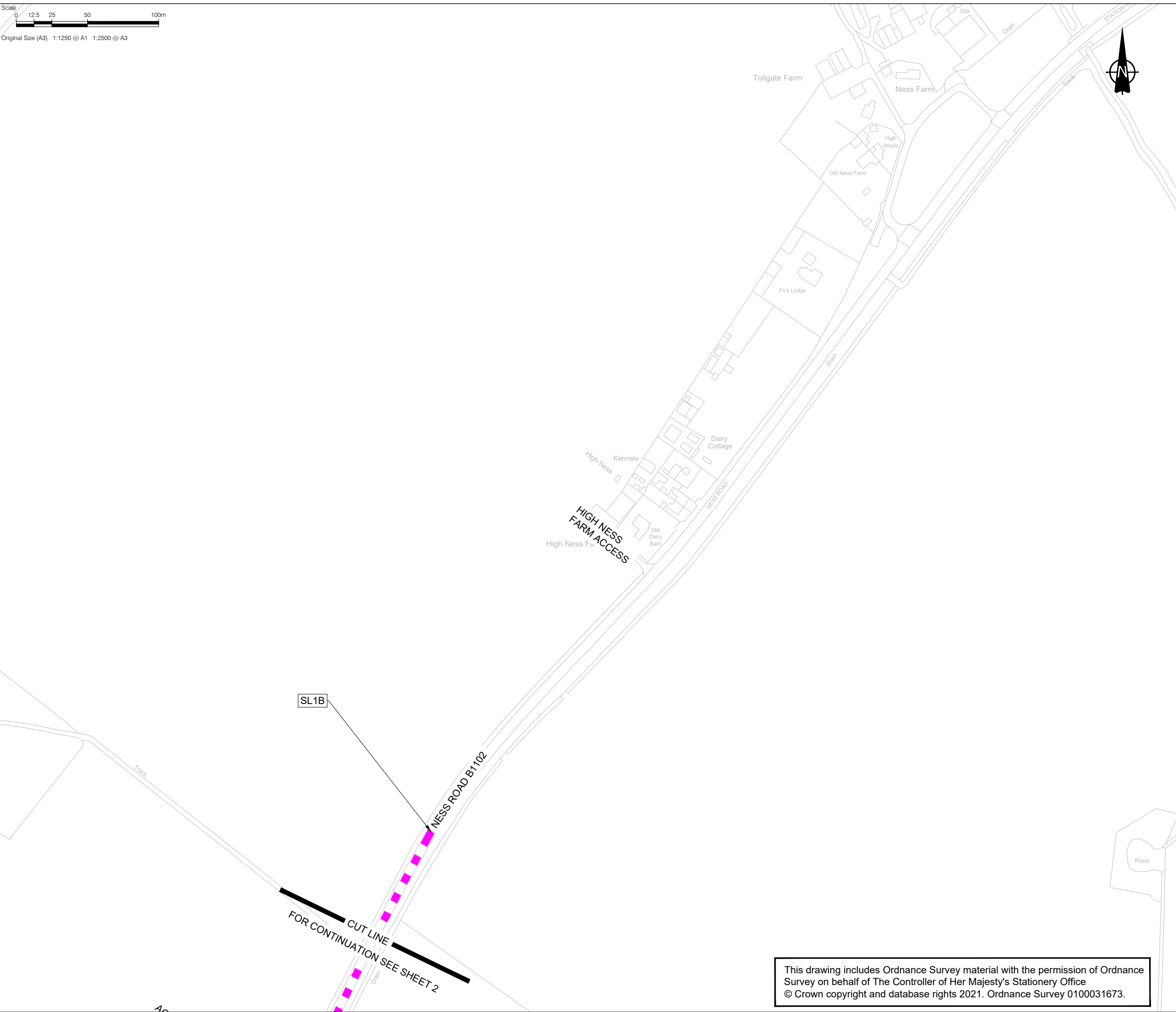

CONSULTANT

AECOM House, 63-77 Victoria Street,
 St. Albans, Hertfordshire, AL1 3ER
 +44(0)1727 535000 tel
 +44(0)1727 535099 fax
 www.aecom.com

PROJECT

Sunnica Energy Farm

CLIENT



NOTE

1. THE TRAFFIC REGULATION MEASURES PLANS SHOULD BE READ IN CONJUNCTION WITH THE DEVELOPMENT CONSENT ORDER AND THE OTHER PLANS AND DOCUMENTS TO BE CERTIFIED BY IT, IN PARTICULAR ARTICLES 11 AND 44 OF, AND SCHEDULES 6 AND 14 TO, THE DEVELOPMENT CONSENT ORDER.
2. THE INDICATIVE ACCESS LOCATIONS SHOWN ON THESE PLANS INDICATE THE GENERAL LOCATION OF THE ACCESSES TO WHICH THE TEMPORARY TRAFFIC SIGNAL MEASURES AND TEMPORARY PROHIBITION MEASURE DESCRIBED IN PARTS 2 AND 4 OF SCHEDULE 14 TO THE DEVELOPMENT CONSENT ORDER, RELATE. THESE PLANS DO NOT SHOW ALL PROPOSED ACCESSES TO THE AUTHORISED DEVELOPMENT. FURTHER INFORMATION ON THE PROPOSED ACCESSES TO THE AUTHORISED DEVELOPMENT CAN BE FOUND IN THE ACCESS AND RIGHTS OF WAY PLANS AND SCHEDULE 7 TO THE DRAFT DCO.
3. THE REQUIREMENT FOR TS1 HAS BEEN REMOVED AND TRAFFIC SIGNALS START AT TS2.

KEY

- ORDER LIMITS
- PROPOSED TEMPORARY SPEED LIMIT (30MPH SPEED LIMIT)
- PROPOSED TEMPORARY SPEED LIMIT (40MPH SPEED LIMIT)
- PROPOSED TEMPORARY TRAFFIC SIGNAL CONTROL AREA
- PROPOSED TEMPORARY PROHIBITION ORDER
- ➔ INDICATIVE SITE ACCESS LOCATION

SHEET PLAN

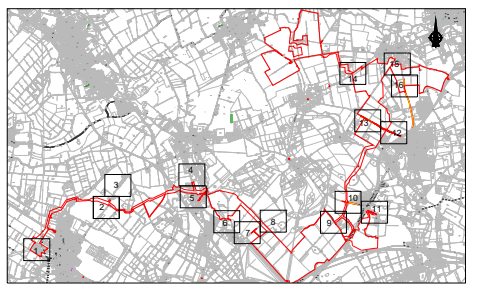

Document Reference: EN010106/APP/2.4

ISSUE/REVISION

I/R	DATE	DESCRIPTION
1	30/08/2022	CHANGE APPLICATION JULY 2022
0	18/11/2021	FOR DCO SUBMISSION

SHEET TITLE

TRAFFIC REGULATION MEASURES PLANS -
 TEMPORARY MEASURES
 INFRASTRUCTURE PLANNING
 (APPLICATIONS: PRESCRIBED FORMS AND
 PROCEDURE) REGULATIONS 2009 5(2)(O)
 SHEET 3 OF 16

SHEET NUMBER

60589004-TRM-TM-003

SCALE

1:2500 @ A3

This drawing includes Ordnance Survey material with the permission of Ordnance Survey on behalf of The Controller of Her Majesty's Stationery Office © Crown copyright and database rights 2021. Ordnance Survey 0100031673.

This drawing has been prepared for the use of AECOM's client. It may not be used, modified, reproduced or relied upon by third parties, except as agreed by AECOM or as required by law. AECOM accepts no responsibility, and denies any liability whatsoever, to any party that uses or relies on this drawing without AECOM's express written consent. Do not scale this document.

Project Management Initials: Designer: DC
 Latest Revision Initials: Checked: DC
 Project Reference Number: 60589004

Last saved by: HATTONCM (2022-08-23) Last Printed: 2022-08-25
 Filename: \\NA.AECOM\NET\COM\FSE\ENEA\STALBANS\UNST\1\LEGACY\PROJECTS\SUNNICA ENERGY FARMES APPLICATION\CAD\TROSS\WP\TRAFFIC REGULATION MEASURES_S9\HEETS_TM.DWG

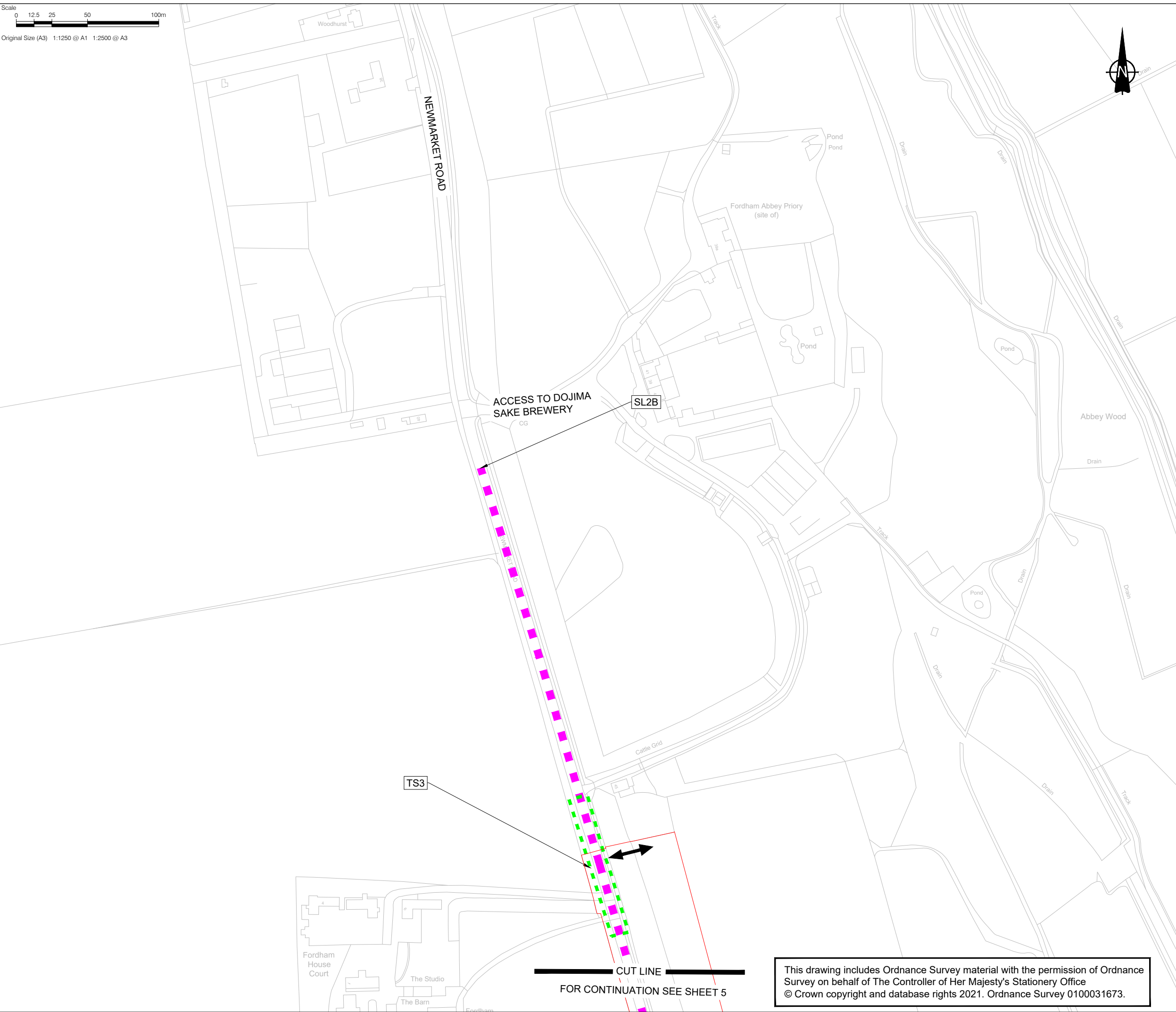

Scale
 0 12.5 25 50 100m
 Original Size (A3) 1:1250 @ A1 1:2500 @ A3



CONSULTANT

AECOM House, 63-77 Victoria Street,
 St. Albans, Hertfordshire, AL1 3ER
 +44(0)1727 535000 tel
 +44(0)1727 535099 fax
 www.aecom.com

PROJECT

Sunnica Energy Farm

CLIENT



NOTE

1. THE TRAFFIC REGULATION MEASURES PLANS SHOULD BE READ IN CONJUNCTION WITH THE DEVELOPMENT CONSENT ORDER AND THE OTHER PLANS AND DOCUMENTS TO BE CERTIFIED BY IT, IN PARTICULAR ARTICLES 11 AND 44 OF, AND SCHEDULES 6 AND 14 TO, THE DEVELOPMENT CONSENT ORDER.
2. THE INDICATIVE ACCESS LOCATIONS SHOWN ON THESE PLANS INDICATE THE GENERAL LOCATION OF THE ACCESSES TO WHICH THE TEMPORARY TRAFFIC SIGNAL MEASURES AND TEMPORARY PROHIBITION MEASURE DESCRIBED IN PARTS 2 AND 4 OF SCHEDULE 14 TO THE DEVELOPMENT CONSENT ORDER, RELATE. THESE PLANS DO NOT SHOW ALL PROPOSED ACCESSES TO THE AUTHORISED DEVELOPMENT. FURTHER INFORMATION ON THE PROPOSED ACCESSES TO THE AUTHORISED DEVELOPMENT CAN BE FOUND IN THE ACCESS AND RIGHTS OF WAY PLANS AND SCHEDULE 7 TO THE DRAFT DCO.
3. THE REQUIREMENT FOR TS1 HAS BEEN REMOVED AND TRAFFIC SIGNALS START AT TS2.

KEY

- ORDER LIMITS
- PROPOSED TEMPORARY SPEED LIMIT (30MPH SPEED LIMIT)
- PROPOSED TEMPORARY SPEED LIMIT (40MPH SPEED LIMIT)
- PROPOSED TEMPORARY TRAFFIC SIGNAL CONTROL AREA
- PROPOSED TEMPORARY PROHIBITION ORDER
- INDICATIVE SITE ACCESS LOCATION

SHEET PLAN

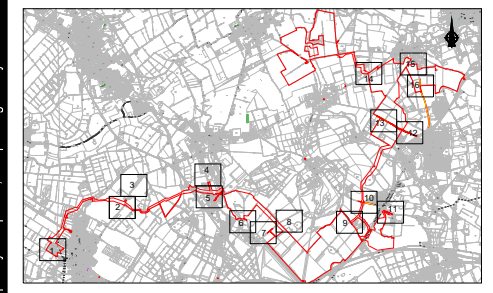

Document Reference: EN010106/APP/2.4

ISSUE/REVISION

I/R	DATE	DESCRIPTION
1	30/08/2022	CHANGE APPLICATION JULY 2022
0	18/11/2021	FOR DCO SUBMISSION

SHEET TITLE

TRAFFIC REGULATION MEASURES PLANS -
 TEMPORARY MEASURES
 INFRASTRUCTURE PLANNING
 (APPLICATIONS: PRESCRIBED FORMS AND
 PROCEDURE) REGULATIONS 2009 5(2)(O)
 SHEET 4 OF 16

SHEET NUMBER

60589004-TRM-TM-004

SCALE

1:2500 @ A3

This drawing includes Ordnance Survey material with the permission of Ordnance Survey on behalf of The Controller of Her Majesty's Stationery Office © Crown copyright and database rights 2021. Ordnance Survey 0100031673.

This drawing has been prepared for the use of AECOM's client. It may not be used, modified, reproduced or relied upon by third parties, except as agreed by AECOM or as required by law. AECOM accepts no responsibility, and denies any liability whatsoever, to any party that uses or relies on this drawing without AECOM's express written consent. Do not scale this document.

Project Management Initials: Designer: DC
 Latest Revision Initials: Checked: DC
 Project Reference Number: 60589004

Checked: CEC Approved: CC
 Checked: CEC Approved: CC

ISO A3 420mm x 297mm
 Original Size (A3) 1:1250 @ A1 1:2500 @ A3

Last saved by: HATTONCM (2022-08-23) Last Printed: 2022-08-25
 Filename: I:\A\AECOM\NET\COM\FSE\ENEA\ST\ALBANS\UNST\1\LEGAC\YD\PROJECTS\UNNICA ENERGY FARMES APPLICATION\CAD\TROSS\WP\TRAFFIC REGULATION MEASURES_S9\HEETS_TM.DWG

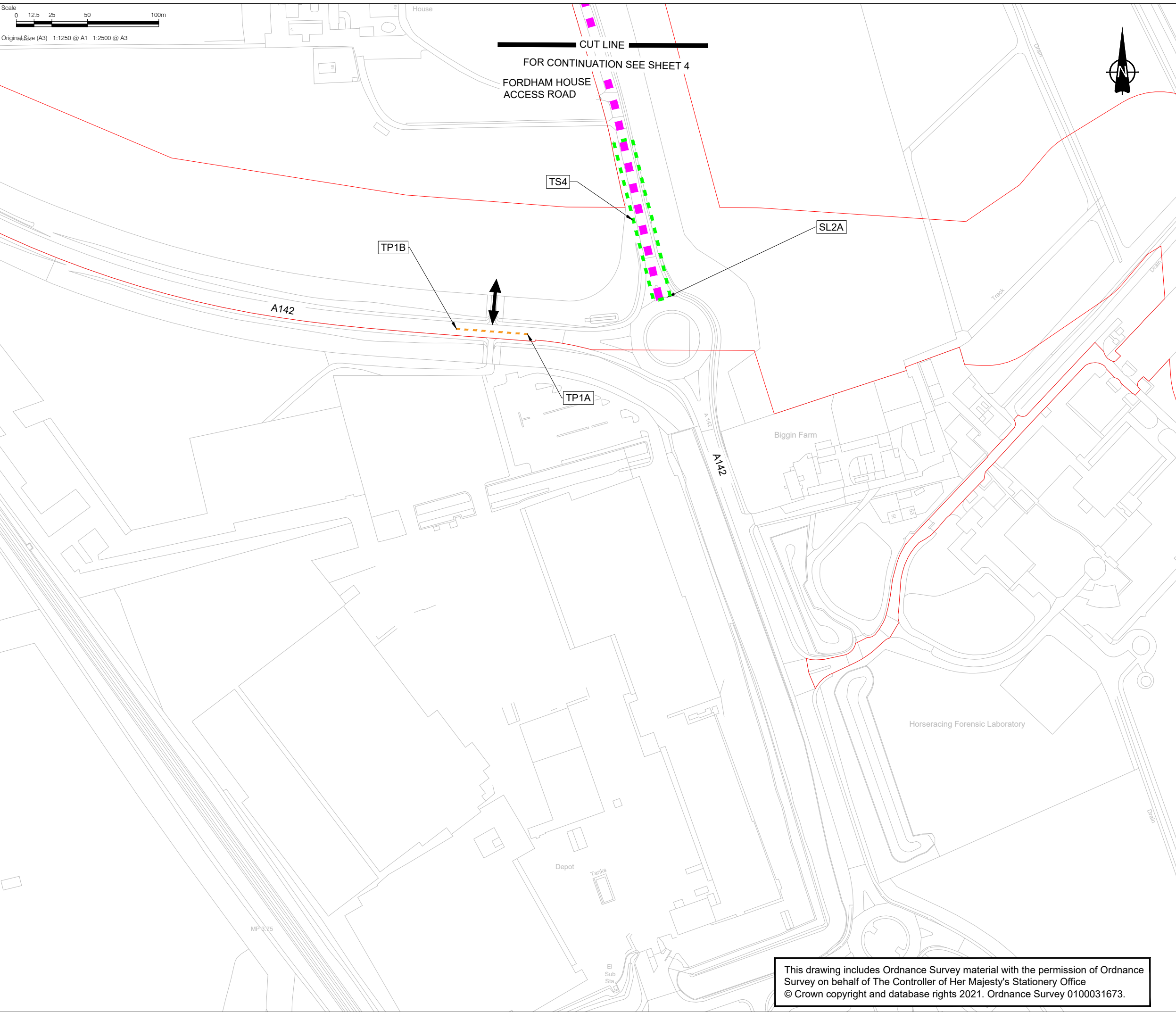

CONSULTANT

AECOM House, 63-77 Victoria Street,
 St. Albans, Hertfordshire, AL1 3ER
 +44(0)1727 535000 tel
 +44(0)1727 535099 fax
 www.aecom.com

PROJECT

Sunnica Energy Farm

CLIENT



NOTE

1. THE TRAFFIC REGULATION MEASURES PLANS SHOULD BE READ IN CONJUNCTION WITH THE DEVELOPMENT CONSENT ORDER AND THE OTHER PLANS AND DOCUMENTS TO BE CERTIFIED BY IT, IN PARTICULAR ARTICLES 11 AND 44 OF, AND SCHEDULES 6 AND 14 TO, THE DEVELOPMENT CONSENT ORDER.
2. THE INDICATIVE ACCESS LOCATIONS SHOWN ON THESE PLANS INDICATE THE GENERAL LOCATION OF THE ACCESSES TO WHICH THE TEMPORARY TRAFFIC SIGNAL MEASURES AND TEMPORARY PROHIBITION MEASURE DESCRIBED IN PARTS 2 AND 4 OF SCHEDULE 14 TO THE DEVELOPMENT CONSENT ORDER, RELATE. THESE PLANS DO NOT SHOW ALL PROPOSED ACCESSES TO THE AUTHORISED DEVELOPMENT. FURTHER INFORMATION ON THE PROPOSED ACCESSES TO THE AUTHORISED DEVELOPMENT CAN BE FOUND IN THE ACCESS AND RIGHTS OF WAY PLANS AND SCHEDULE 7 TO THE DRAFT DCO.
3. THE REQUIREMENT FOR TS1 HAS BEEN REMOVED AND TRAFFIC SIGNALS START AT TS2.

KEY

- ORDER LIMITS
- PROPOSED TEMPORARY SPEED LIMIT (30MPH SPEED LIMIT)
- PROPOSED TEMPORARY SPEED LIMIT (40MPH SPEED LIMIT)
- PROPOSED TEMPORARY TRAFFIC SIGNAL CONTROL AREA
- PROPOSED TEMPORARY PROHIBITION ORDER
- ↔ INDICATIVE SITE ACCESS LOCATION

SHEET PLAN

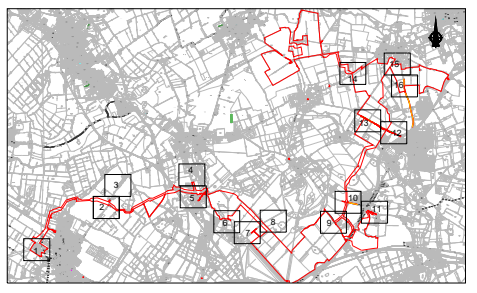

Document Reference: EN010106/APP/2.4

ISSUE/REVISION

I/R	DATE	DESCRIPTION
1	30/08/2022	CHANGE APPLICATION JULY 2022
0	18/11/2021	FOR DCO SUBMISSION

SHEET TITLE

TRAFFIC REGULATION MEASURES PLANS -
 TEMPORARY MEASURES
 INFRASTRUCTURE PLANNING
 (APPLICATIONS: PRESCRIBED FORMS AND
 PROCEDURE) REGULATIONS 2009 5(2)(O)
 SHEET 5 OF 16

SHEET NUMBER

60589004-TRM-TM-005

SCALE

1:2500 @ A3

This drawing includes Ordnance Survey material with the permission of Ordnance Survey on behalf of The Controller of Her Majesty's Stationery Office © Crown copyright and database rights 2021. Ordnance Survey 0100031673.

This drawing has been prepared for the use of AECOM's client. It may not be used, modified, reproduced or relied upon by third parties, except as agreed by AECOM or as required by law. AECOM accepts no responsibility, and denies any liability whatsoever, to any party that uses or relies on this drawing without AECOM's express written consent. Do not scale this document.

Project Management Initials: Designer: DC
 Latest Revision Initials: Checked: DC
 Project Reference Number: 60589004

Checked: CEC Approved: CC ISO A3 420mm x 297mm
 Checked: CEC Approved: CC ISO A3 420mm x 297mm
 Checked: CEC Approved: CC ISO A3 420mm x 297mm

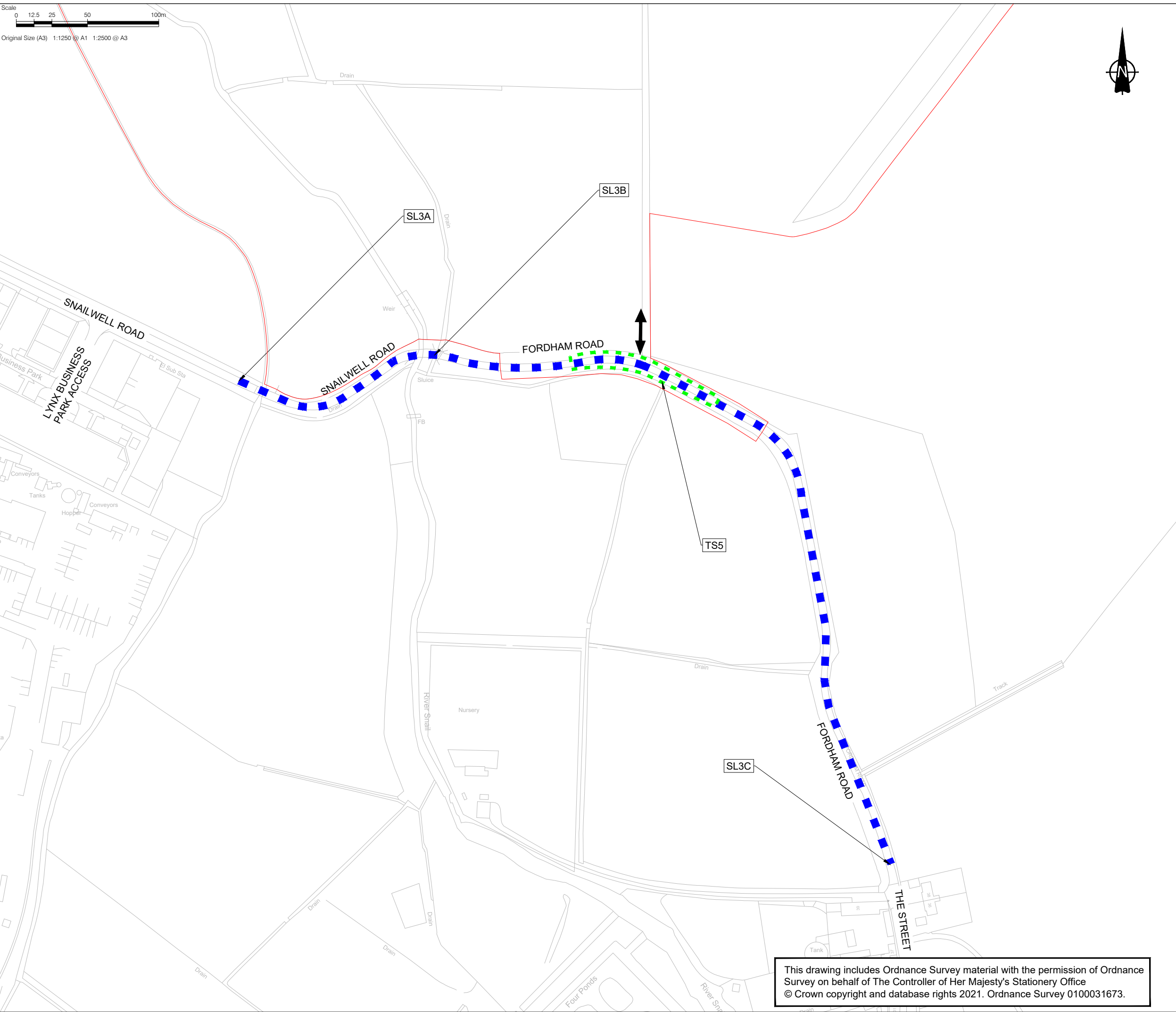

Scale
 0 12.5 25 50 100m
 Original Size (A3) 1:1250 @ A1 1:2500 @ A3



CONSULTANT

AECOM House, 63-77 Victoria Street,
 St. Albans, Hertfordshire, AL1 3ER
 +44(0)1727 535000 tel
 +44(0)1727 535099 fax
 www.aecom.com

PROJECT

Sunnica Energy Farm

CLIENT



NOTE

1. THE TRAFFIC REGULATION MEASURES PLANS SHOULD BE READ IN CONJUNCTION WITH THE DEVELOPMENT CONSENT ORDER AND THE OTHER PLANS AND DOCUMENTS TO BE CERTIFIED BY IT, IN PARTICULAR ARTICLES 11 AND 44 OF, AND SCHEDULES 6 AND 14 TO, THE DEVELOPMENT CONSENT ORDER.
2. THE INDICATIVE ACCESS LOCATIONS SHOWN ON THESE PLANS INDICATE THE GENERAL LOCATION OF THE ACCESSES TO WHICH THE TEMPORARY TRAFFIC SIGNAL MEASURES AND TEMPORARY PROHIBITION MEASURE DESCRIBED IN PARTS 2 AND 4 OF SCHEDULE 14 TO THE DEVELOPMENT CONSENT ORDER, RELATE. THESE PLANS DO NOT SHOW ALL PROPOSED ACCESSES TO THE AUTHORISED DEVELOPMENT. FURTHER INFORMATION ON THE PROPOSED ACCESSES TO THE AUTHORISED DEVELOPMENT CAN BE FOUND IN THE ACCESS AND RIGHTS OF WAY PLANS AND SCHEDULE 7 TO THE DRAFT DCO.
3. THE REQUIREMENT FOR TS1 HAS BEEN REMOVED AND TRAFFIC SIGNALS START AT TS2.

KEY

- ORDER LIMITS
- PROPOSED TEMPORARY SPEED LIMIT (30MPH SPEED LIMIT)
- PROPOSED TEMPORARY SPEED LIMIT (40MPH SPEED LIMIT)
- PROPOSED TEMPORARY TRAFFIC SIGNAL CONTROL AREA
- PROPOSED TEMPORARY PROHIBITION ORDER
- ↔ INDICATIVE SITE ACCESS LOCATION

SHEET PLAN

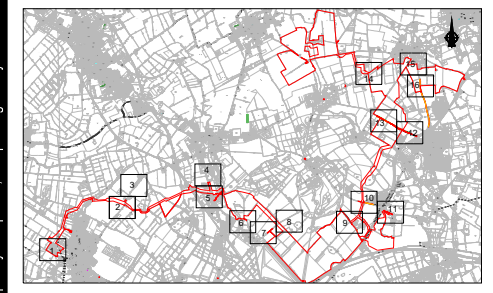

Document Reference: EN010106/APP/2.4

ISSUE/REVISION

I/R	DATE	DESCRIPTION
1	30/08/2022	CHANGE APPLICATION JULY 2022
0	18/11/2021	FOR DCO SUBMISSION

SHEET TITLE

TRAFFIC REGULATION MEASURES PLANS -
 TEMPORARY MEASURES
 INFRASTRUCTURE PLANNING
 (APPLICATIONS: PRESCRIBED FORMS AND
 PROCEDURE) REGULATIONS 2009 5(2)(O)
 SHEET 6 OF 16

SHEET NUMBER

60589004-TRM-TM-006

SCALE

1:2500 @ A3

This drawing includes Ordnance Survey material with the permission of Ordnance Survey on behalf of The Controller of Her Majesty's Stationery Office © Crown copyright and database rights 2021. Ordnance Survey 0100031673.

This drawing has been prepared for the use of AECOM's client. It may not be used, modified, reproduced or relied upon by third parties, except as agreed by AECOM or as required by law. AECOM accepts no responsibility, and denies any liability whatsoever, to any party that uses or relies on this drawing without AECOM's express written consent. Do not scale this document.

Project Management Initials: Designer: DC
 Latest Revision Initials: Checked: CC
 Project Reference Number: 60589004

Scale
 0 12.5 25 50 100m
 Original Size (A3) 1:1250 @ A1 1:2500 @ A3



CONSULTANT

AECOM House, 63-77 Victoria Street,
 St. Albans, Hertfordshire, AL1 3ER
 +44(0)1727 535000 tel
 +44(0)1727 535099 fax
 www.aecom.com

PROJECT

Sunnica Energy Farm

CLIENT



NOTE

1. THE TRAFFIC REGULATION MEASURES PLANS SHOULD BE READ IN CONJUNCTION WITH THE DEVELOPMENT CONSENT ORDER AND THE OTHER PLANS AND DOCUMENTS TO BE CERTIFIED BY IT, IN PARTICULAR ARTICLES 11 AND 44 OF, AND SCHEDULES 6 AND 14 TO, THE DEVELOPMENT CONSENT ORDER.
2. THE INDICATIVE ACCESS LOCATIONS SHOWN ON THESE PLANS INDICATE THE GENERAL LOCATION OF THE ACCESSES TO WHICH THE TEMPORARY TRAFFIC SIGNAL MEASURES AND TEMPORARY PROHIBITION MEASURE DESCRIBED IN PARTS 2 AND 4 OF SCHEDULE 14 TO THE DEVELOPMENT CONSENT ORDER, RELATE. THESE PLANS DO NOT SHOW ALL PROPOSED ACCESSES TO THE AUTHORISED DEVELOPMENT. FURTHER INFORMATION ON THE PROPOSED ACCESSES TO THE AUTHORISED DEVELOPMENT CAN BE FOUND IN THE ACCESS AND RIGHTS OF WAY PLANS AND SCHEDULE 7 TO THE DRAFT DCO.
3. THE REQUIREMENT FOR TS1 HAS BEEN REMOVED AND TRAFFIC SIGNALS START AT TS2.

KEY

- ORDER LIMITS
- PROPOSED TEMPORARY SPEED LIMIT (30MPH SPEED LIMIT)
- PROPOSED TEMPORARY SPEED LIMIT (40MPH SPEED LIMIT)
- PROPOSED TEMPORARY TRAFFIC SIGNAL CONTROL AREA
- PROPOSED TEMPORARY PROHIBITION ORDER
- INDICATIVE SITE ACCESS LOCATION

SHEET PLAN

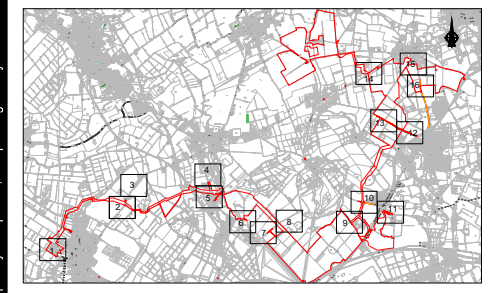

Document Reference: EN010106/APP/2.4

ISSUE/REVISION

I/R	DATE	DESCRIPTION
1	30/08/2022	CHANGE APPLICATION JULY 2022
0	18/11/2021	FOR DCO SUBMISSION

SHEET TITLE

TRAFFIC REGULATION MEASURES PLANS -
 TEMPORARY MEASURES
 INFRASTRUCTURE PLANNING
 (APPLICATIONS: PRESCRIBED FORMS AND
 PROCEDURE) REGULATIONS 2009 5(2)(O)
 SHEET 7 OF 16

SHEET NUMBER

60589004-TRM-TM-007

SCALE

1:2500 @ A3

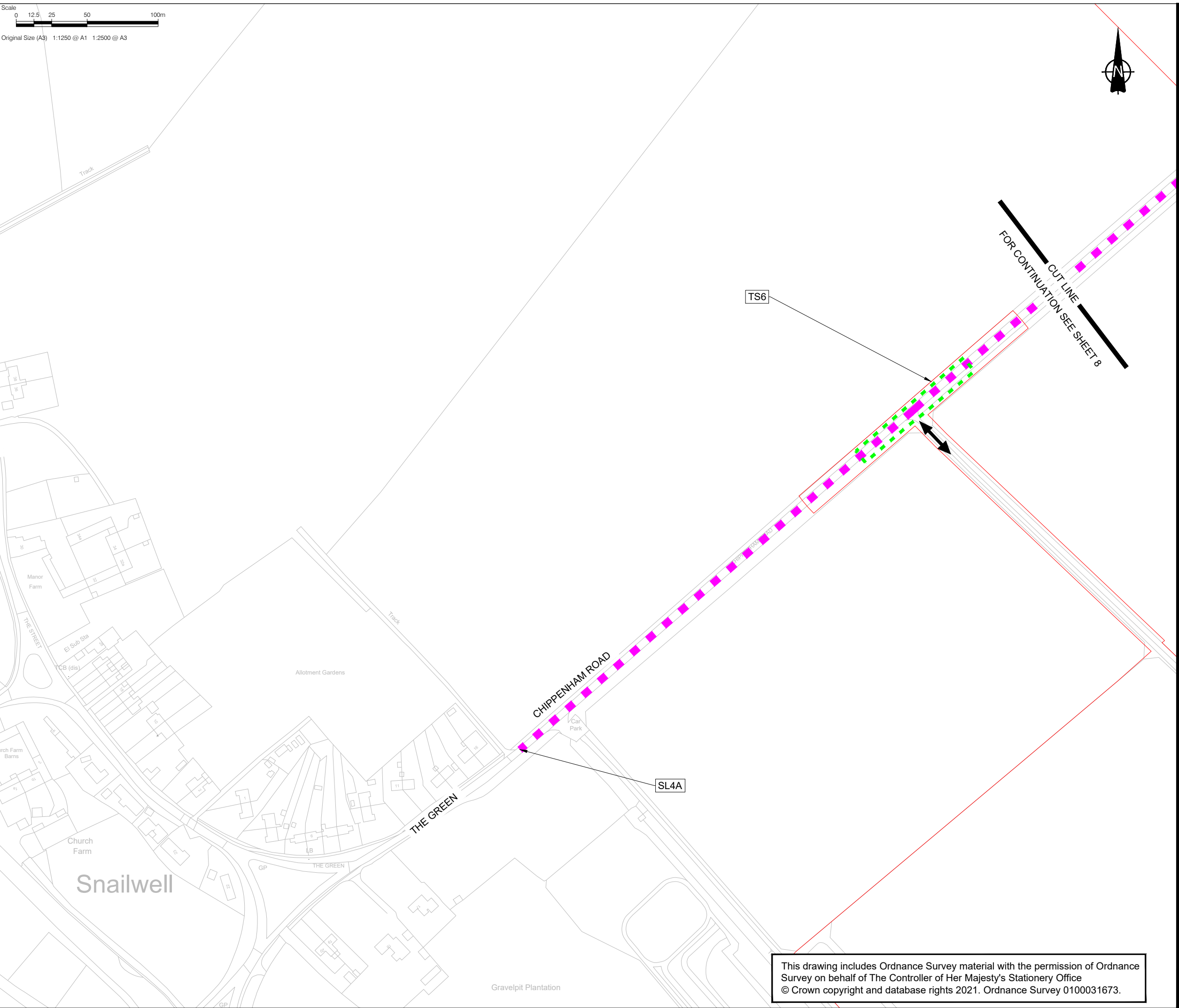

This drawing includes Ordnance Survey material with the permission of Ordnance Survey on behalf of The Controller of Her Majesty's Stationery Office © Crown copyright and database rights 2021. Ordnance Survey 0100031673.

Last saved by: HATTONCM (2022-08-23) Last Printed: 2022-08-23
 Filename: \\NA.AECOM\NET\COM\FSE\ENEA\STALBANS\UNST\1\LEGACY\PROJECTS\SUNNICA ENERGY FARMES APPLICATION\CA\TRM\TS\WPT\TRAFFIC REGULATION MEASURES_SHEET6_TM.DWG

This drawing has been prepared for the use of AECOM's client. It may not be used, modified, reproduced or relied upon by third parties, except as agreed by AECOM or as required by law. AECOM accepts no responsibility, and denies any liability whatsoever, to any party that uses or relies on this drawing without AECOM's express written consent. Do not scale this document.